

testo 174T BT / testo 174H BT

0572 1742 01 / 0572 1743 01

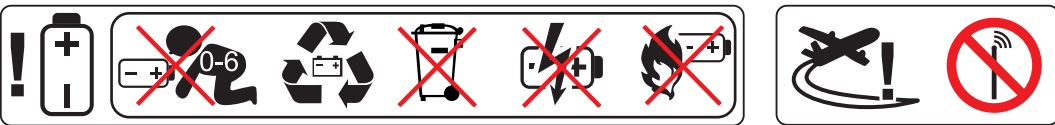

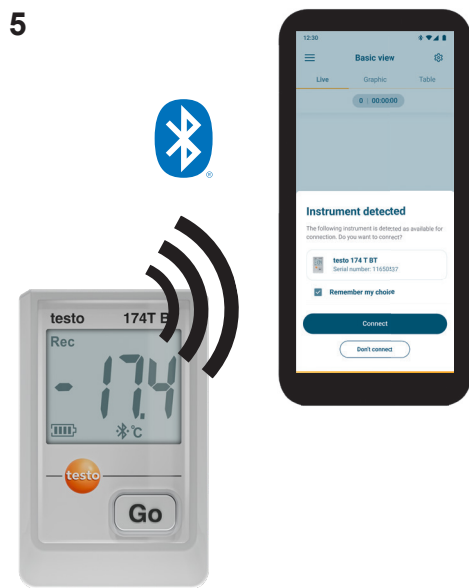

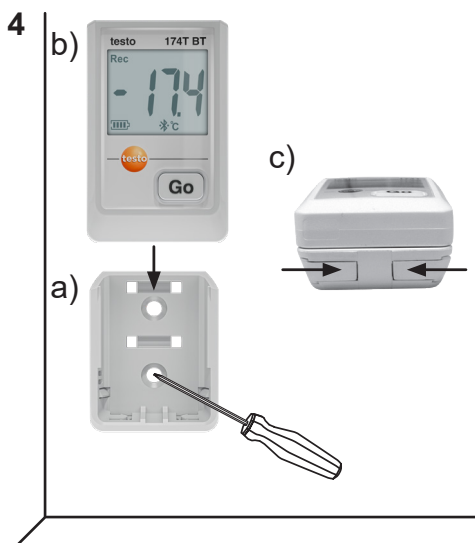
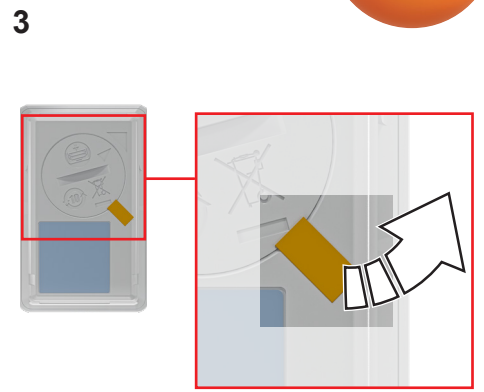
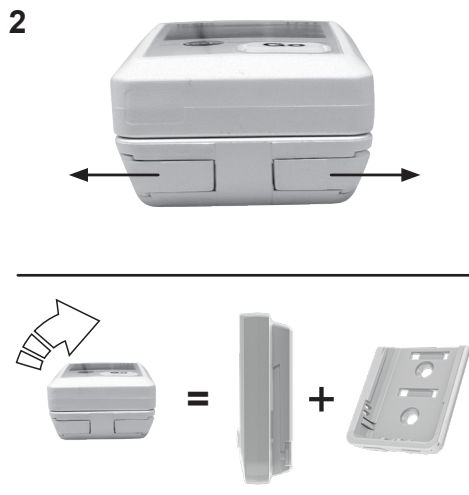



<p>60 x 38 x 19 mm 2.4 x 1.5 x 0.7 in</p>	<p>testo 174T: -30 ... +70 °C -22 ... +158 °F</p> <p>testo 174H: -20 ... +70 °C -4 ... +158 °F</p> <p>-40 ... +70 °C -40 ... +158 °F</p>	<p>2x 3 V (CR 2032 Lithium)</p> <p>testo 174T BT: 500 days 15 min meas. cycle, +25 °C / 77 °F)</p> <p>testo 174H BT: 1 year 15 min meas. cycle, +25 °C / 77 °F)</p>	<p>testo 174T BT: 0.1 °C 0.1 °F</p> <p>testo 174H BT: 0.1 °C 0.1 °F 0.1 % RH</p>	<p>testo 174T BT: T: -30 ... +70 °C -22 ... +158 °F</p> <p>testo 174H BT: -20 ... +70 °C -4 ... +158 °F (0 ... 100 % RH)</p>	<p>testo 174T BT: ± 0.5 °C (-30 ... +70 °C) ± 0.5 °F (-22 ... +158 °F)</p> <p>testo 174H BT: ± 0.5 °C (-20 ... +70 °C) ± 0.5 °F (4 ... +158 °F) ± 3 % RH (2 % RH ... 98 % RH) @ 25 °C ± 0.03 % RH/K ± 1 digit</p>	<p>35 g 1.2 oz</p> <p>testo 174T BT: IP 65</p> <p>testo 174H BT: IP 20</p>

Approval and Certification

Product	testo 174T BT testo 174H BT
Model	0572 1742 0572 1743
Mat.-No.	0572 1742 01 0572 1743 01
Date	17.10.2024

 The use of the wireless module is subject to the regulations and stipulations of the respective country of use, and the module may only be used in countries for which a country certification has been granted. The user and every owner has the obligation to adhere to these regulations and prerequisites for use, and acknowledges that the re-sale, export, import etc. in particular in countries without wireless permits, is his responsibility.

Country	Comments
Canada	For testo 174T BT: 6127B-05721742 For testo 174H BT: 6127B-05721743 See IC Warnings
Europa + EFTA	  Hereby, Testo SE & Co. KGaA declares that the radio equipment types testo 174 T BT (0572 1742) and testo 174 H BT (0572 1743) are in compliance with Directive 2014/53/EU. The full text of the EU declaration of conformity is available at the following internet address: https://www.testo.com/eu-conformity EU countries: Belgium (BE), Bulgaria (BG), Denmark (DK), Germany (DE), Estonia (EE), Finland (FI), France (FR), Greece (GR), Ireland (IE), Italy (IT), Latvia (LV), Lithuania (LT), Luxembourg (LU), Malta (MT), Netherlands (NL), Austria (AT), Poland (PL), Portugal (PT), Romania (RO), Sweden (SE), Slovakia (SK), Slovenia (SI), Spain (ES), Czech Republic (CZ), Hungary (HU), Republic of Cyprus (CY). EFTA countries: Iceland, Liechtenstein, Norway, Switzerland  WEEE Reg. no.: DE 75334352
Japan	Contains 0344 0050 BLE module  204-B00974 See Japan information
India	Approved
United Kingdom (UK)	  The UK Declaration of Conformity can be found on the testo homepage www.testo.com under the product specific downloads.
USA	 For testo 174T BT: WAF-05721742 For testo 174H BT: WAF-05721743 See FCC Warnings

Bluetooth® Information / 蓝牙信息	Feature 特征与参数	Values 数值
	Bluetooth® range / 范围	up to 30 m (98 feet) (free field / 无障碍场地)
	Radio Type / 无线类型	Bluetooth® Low Energy (BLE)
	Company / 制造商	Testo SE & Co. KGaA testo 0344 0050
	RF Band / 射频频段	2402 – 2480 MHz
	Power output / 输出功率	< 10 dBm
Bluetooth® SIG List	Design Number	Q305931
	Member company	Testo SE & Co. KGaA

NSF	For testo 174T BT: 
EN12830	For testo 174T BT: Acc. to EN12830-S, T, 0,5 Ia

	Comments
Hongkong	Approved

IC Warnings

CAN ICES-003(B)/NMB-003(B)

This Class B digital apparatus complies with Canadian ICES-003.

Cet appareil numérique de la classe B est conforme à la norme NMB-003 du Canada.

RSS-Gen & RSS-247 statement

This device contains licence-exempt transmitter(s)/receiver(s) that comply with Innovation, Science and Economic Development Canada's licence-exempt RSS(s).

Operation is subject to the following two conditions:

- (1) this device may not cause interference, and
- (2) this device must accept any interference, including interference that may cause undesired operation of the device.

L'émetteur/récepteur exempt de licence contenu dans le présent appareil est conforme aux CNR d'Innovation, Sciences et Développement économique Canada applicables aux appareils radio exempts de licence. L'exploitation est autorisée aux deux conditions suivantes:

- (1) L'appareil ne doit pas produire de brouillage.
- (2) L'appareil doit accepter tout brouillage radioélectrique subi, même si le brouillage est susceptible d'en compromettre le fonctionnement.

Caution: Radio Frequency Radiation Exposure

This equipment complies with IC radiation exposure limits set forth for an uncontrolled environment and meets the IC radio frequency (RF) Exposure Guidelines. This equipment should be installed and operated keeping the radiator at least 20 cm or more away from person's body in normal use position to ensure compliance with RF exposure requirement.

Co-Location

This device must not be co-located or operated in conjunction with any other antenna or transmitter.

Attention : exposition au rayonnement de radiofréquences

Cet équipement est conforme aux limites d'exposition aux radiofréquences IC fixées pour un environnement non contrôlé et aux Lignes directrices relatives à l'exposition aux radiofréquences (RF). Cet équipement doit être installé et utilisé en gardant le radiateur à une distance d'au moins 20 cm du corps humain en position normale d'utilisation pour garantir la conformité à l'exposition aux RF.

Co-location

Ce dispositif ne doit pas être utilisé à proximité d'une autre antenne ou d'un autre émetteur.

FCC Warnings

Information from the FCC (Federal Communications Commission)

For your own safety

Shielded cables should be used for a composite interface. This is to ensure continued protection against radio frequency interference.

FCC warning statement

This equipment has been tested and found to comply with the limits for a Class B digital device, pursuant to Part 15 of the FCC Rules. These limits are designed to provide reasonable protection against harmful interference in a residential installation. This equipment generates, uses and can radiate radio frequency energy and, if not installed and used in accordance with the instructions, may cause harmful interference to radio communications. However, there is no guarantee that interference will not occur in a particular installation. If this equipment does cause harmful interference to radio or television reception, which can be determined by turning the equipment off and on, the user is encouraged to try to correct the interference by one or more of the following measures:

- Reorient or relocate the receiving antenna.
- Increase the separation between the equipment and receiver.
- Connect the equipment into an outlet on a circuit different from that to which the receiver is connected.
- Consult the dealer or an experienced radio/TV technician for help.

Caution

Changes or modifications not expressly approved by the party responsible for compliance could void the user's authority to operate the equipment. Shielded interface cable must be used in order to comply with the emission limits.

Warning

This device complies with Part 15 of the FCC Rules.

Operation is subject to the following two conditions:

- (1) this device may not cause harmful interference, and
- (2) this device must accept any interference received, including interference that may cause undesired operation.

Caution: Radio Frequency Radiation Exposure

This equipment complies with FCC radiation exposure limits set forth for an uncontrolled environment and meets the FCC radio frequency (RF) Exposure Guidelines. This equipment should be installed and operated keeping the radiator at least 20 cm or more away from person's body in normal use position to ensure compliance with RF exposure requirement.

Co-Location

This device must not be co-located or operated in conjunction with any other antenna or transmitter.

Japan Information

当該機器には電波法に基づく、技術基準適合証明等を受けた特定無線設備を装着している。

Manufacturer/ importer

Testo SE & Co. KG aA

Celsiusstr. 2, 79822 Titisee-Neustadt, Germany

+49 7653 / 681-0

www.testo.com

Warning: Please follow the instructions when using the product.